

TRAFFIC FLOW CHART

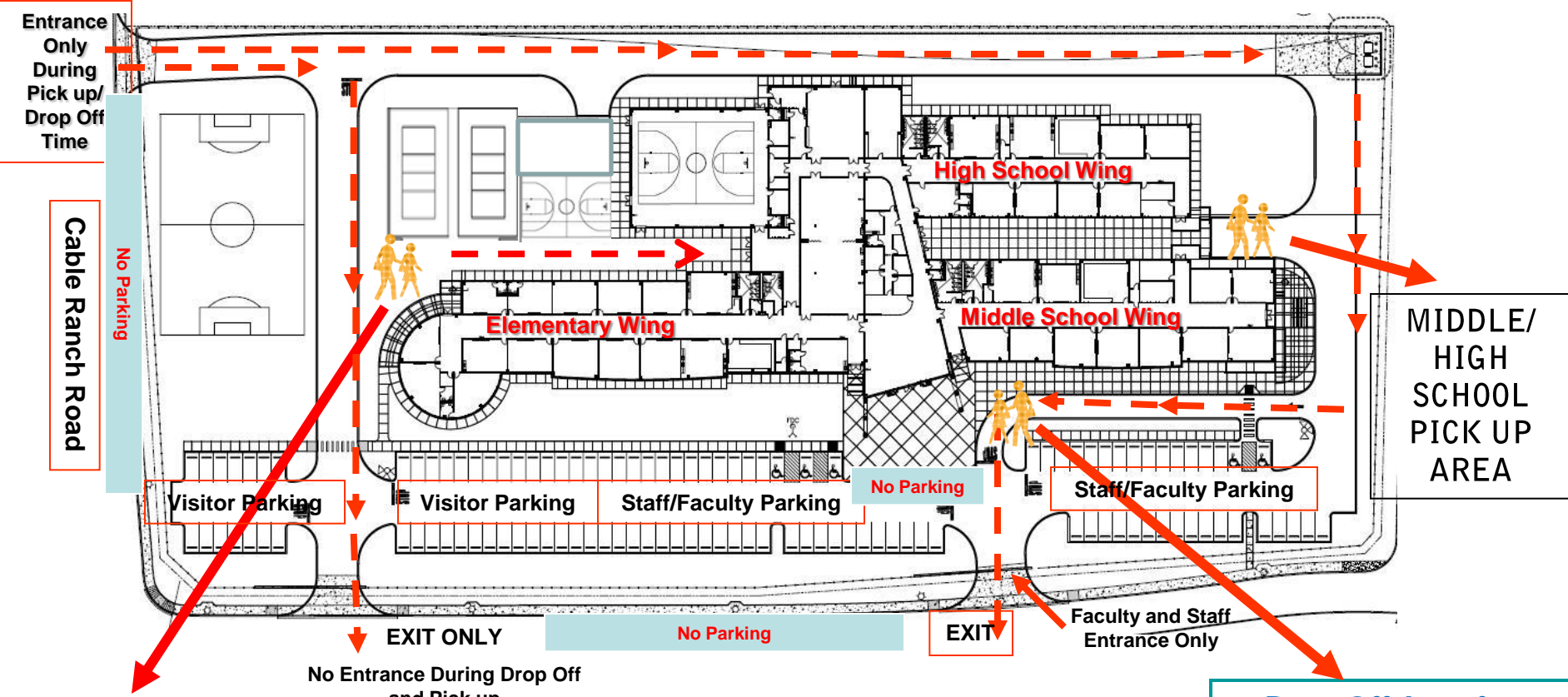

**K-5 GRADE
DROP
OFF/PICK UP
AREA**

Drop Off Procedures:

The back gate (Off Cable Ranch Rd) is the **entrance only** for drop off. Parents can turn right once they enter towards the Kindergarten rooms to drop off their child. Children will walk between the gym and the elementary wing to enter the building at 7:30am. Parents will then exit to from the gate directly in front of them. Parents can also turn left or right into the visitor parking and walk their child into the school.

Parents will also have the option of entering the back gate and driving forward and turning right around the high school wing. The students will be dropped off in front of the middle school wing and will enter the building from the middle school entrance at 7:30am.

Pick Up Line:

The back gate (off Cable Ranch Rd) is the **entrance only** for pick up. Parents can turn right once they enter towards the Kindergarten rooms to pick up K thru 5th grades then leave from the gate directly in front of them, or park in the lot to their right or left in front of the athletic field or kindergarten rooms and walk over to pick up their child from the basketball courts.

Parents will also have the option of entering the back gate and going straight and turning to the right around the high school and middle school wings. They can pick up their middle school/ high school children and leave from the front gate.

**Drop Off Area for
Middle/High Students**

Parents can not drop their children off outside the front gate or enter the faculty/staff entrance during drop off or pick up. Parents who choose to put their child in danger by dropping off their child in a no parking zone or outside of the gate, your plate number will be given to police department!